

CABLE MANAGEMENT SYSTEM CATALOGUE

KIVOLT
TRADING COMPANY

▲ www.kivolt-lb.com

INDEX.

About Us	3
Factories	4
Cable Management System	8
Technical Specification	9
Cable Tray	10
Cable Tray Fittings	13
Cable Tray Accessories	15
Cable Trunking	16
Cable Trunking Fittings	18
Cable Trunking Accessories	20
Cable Ladder	21
Cable Ladder Fittings	24
Cable Ladder Accessories	26
Support System	27

ABOUT US

We, in KIVOLT Team, aim not just to conduct business with our clients but to make win-win situations through adding value by supporting them with our expertise, knowledge and highly technical team. Our products and services are of high quality and high cost efficiency at the same time because we believe that this is the perfect combination in any market and at any level.

The company trades building and construction material that conform with international standards of quality and safety that are manufactured in international factories equipped with high tech robotics, welding machines, CNC machines and an in-house Galvanization facility.

Looking forward for future collaboration.

Kivolt Team

FACTORIES

SFSP

STANDARDS

MATERIALS



FACTORIES

SFSP is a leading manufacturer and fabricator of steel and aluminum products used for the support of equipment for industrial, commercial, utility and OEM installations. Our customers have access to the most complete support systems offered in the industry including metal framings, cable trays, pipe hangers, slotted angles, fasteners and others. *(SFSP is equipped with an in-house hot dip galvanization facility).*

HOT-DIP GALVANIZATION PROCESS



CNC MACHINES

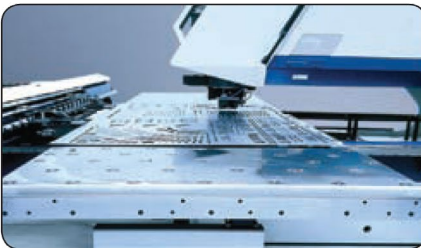

ROLL FORMING MACHINE

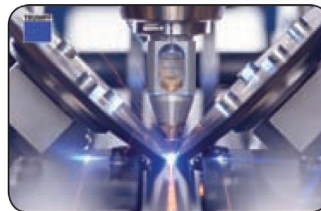

www.sfsp-ikk.com

Specialized Factory for Steel Products (Jeddah/KSA)
 Sigma Factory for Steel Products (Ajman & Umm Al Quwain /UAE)
 Specialized Factory for Steel Products (6th of October/Egypt)
 Specialized Factory for Steel Products (Amman/Jordan)

KIVOLT cable management and accessories from SFSP are manufactured in compliance with :

- NEMA VE 1–2009
- NEMA VE 2–2006
- IEC 61537
- BS EN 61537:2007
- BS 5750/BS EN 10130
- BS EN 10131
- BS EN 10051
- CENELEC EN 50173-1
- EIA/ITA 568 A
- ISO/IEC 11801; 2002.



Cable Management items are designed to meet most requirements of cable and electrical wire installations and comply to local and international standards of fabrication and finishing.

This catalogue is designed to be helpful to engineers and contractors in the application and selection of products for construction and maintenance. If a unique application requires a special product not included in this catalogue, KIVOLT engineering personnel are ready to furnish design consultation and realistic cost estimates. In addition, know-how are available for your convenience.

A. Cable Tray is used for carrying multiple runs of armored and sheathed cables

B. Cable Trunking is used to route and protect unarmored cables in various types of buildings

C. Cable Ladder consists of two shaped longitudinal sides connected together by transverse rungs

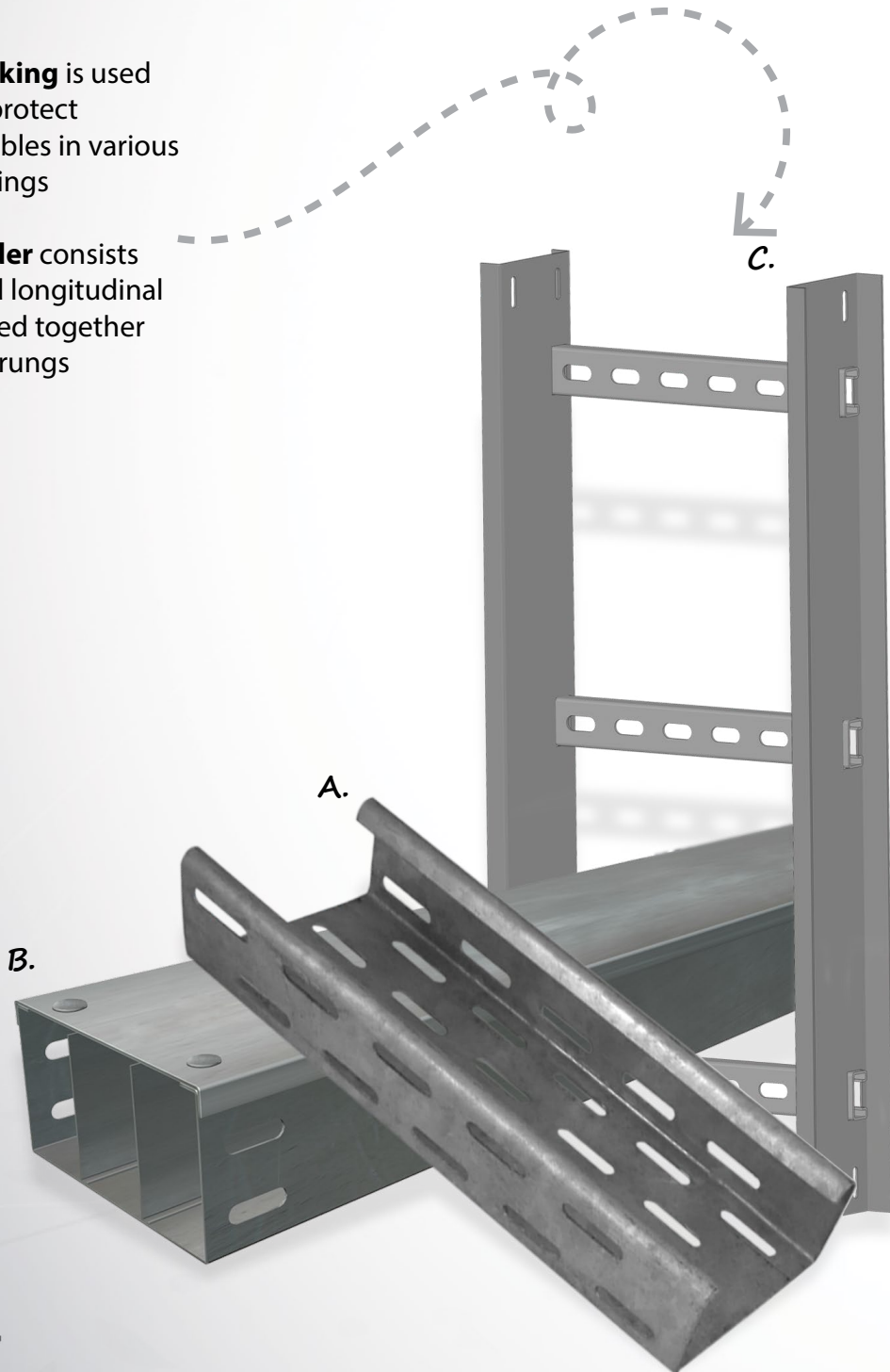

TECHNICAL SPECIFICATION

RAW MATERIALS

-Mild Steel (MS)

For cold rolled steel : according to EN 10130 , ASTM A 366

For hot rolled steel : according to EN 10025-2 , ASTM A 907

-Galvanized Steel (MG)

Continuously hot-dip coated strip and sheet: according to EN 10327

ASTM A 653 M

-Stainless Steel (SS)

Austenitic Stainless Steel SS 304 & 316 : according to EN 10088-1:2005

ASTM A 240

-Aluminum (AL)

Sheet : Aluminum Alloy 1100 according to ASTM B 209 (For Cable Tray & Trunk Only)

Extrusion Profiles : Aluminum Alloy 6061 according to ASTM B 209

Aluminum Alloy 6063 T6 according to EN 755-2 (For Cable Ladder)

FINISHES FOR MILD STEEL

-Hot Dipped Galvanized after fabrication (HDG)

According to EN ISO 1461 , BS 729 , ASTM A 123

-Electro- Galvanized Steel (EG)

According to ISO 2081 , ASTM B 633

-Powder Coated (PC)

According to BS 3900 , ISO 2409

CABLE TRAY

Kivolt cable management and accessories are manufactured in compliance with BS EN 61537, 2001/BS 5750/ BS EN 10130/ BS EN 10131/ BS EN 10051 and NEMA standards. And, as per cabling standards CENELEC EN 50173-1; EIA/ ITA 568 A; ISO/ IEC 11801; 2002.

1. FEATURES

- Straight Type , Returned Flange Inside Type ,
Returned flange Outside Type

STR

Straight

RFI

Returned Flange Inside

RFO

Returned Flange Outside

- Perforated Type

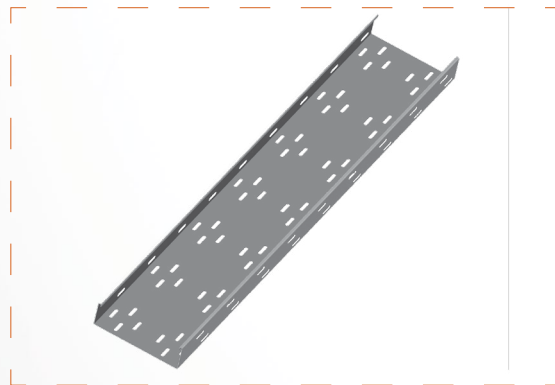

2. SPECIFICATION

-Refer to page 9

3. LOAD CAPACITY

-Please contact our technical team to provide you with the suitable load capacity , support spacing and actual deflection .

CABLE TRAY

FOR STRAIGHT CABLE TRAY

The below table show the standard dimensions and finishing's for Perforated Cable Tray.

Width (mm)	50	100	150	200	250	300	400	450	500	600	700	750	800	900	1000
Height (mm)	100		75			60			50			150			
Thickness (mm)	1.0			2			1.5			1.2					
Length (m)	3			2.44			2								
Type of Flange	STR			RFI			RFO								
Finishing	EG	MG	HDG	SS304	SS316	AL 1100									

For other dimensions ..feel free to contact Kivolt Team.

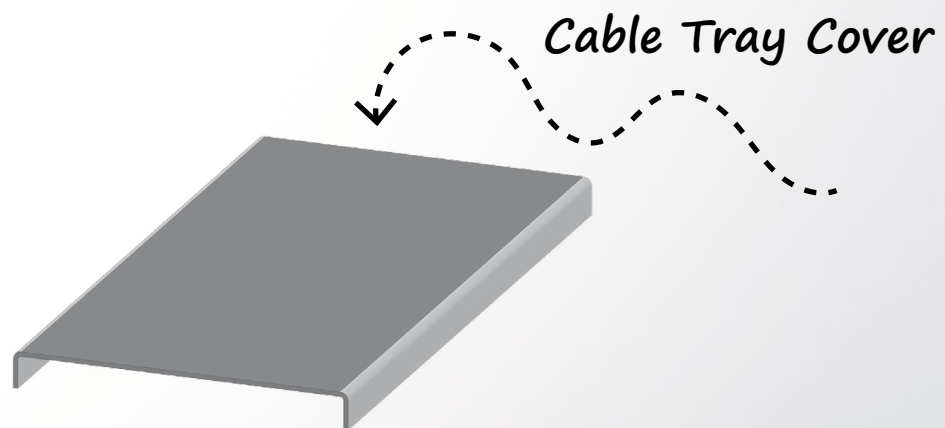

CABLE TRAY

HOW TO ORDER STRAIGHT CABLE TRAY & ITS COVER

- 1- Refer to page 9 to select the finishing for Mild Steel or the type of Material
- 2- Select CT for cable tray
- 3- Select the width , height
- 4- Select the thickness
- 5- Select the length
- 6- Select Type of Flange
- 7- Select Cover by adding it after specifying the length for the tray

Order Example :

To select hot dipped galvanized cable tray with inside returned flange of width 100 mm , side height 50 mm , thickness 1.5 mm and length 3 m.

This is the answer HDG-CT-10050-1.5-3-RFI

To select cover for this hot dipped galvanized cable tray, with thickness 1.2 mm.

This is the answer HDG-CT-10050-1.2-3-RFI-Cover

CABLE TRAY FITTINGS

Bend 45°

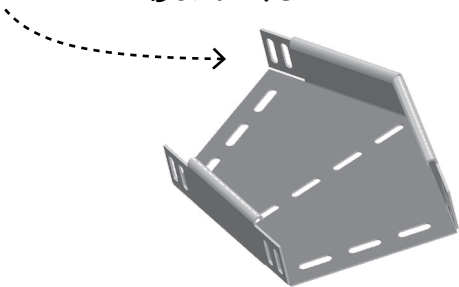

Intersection

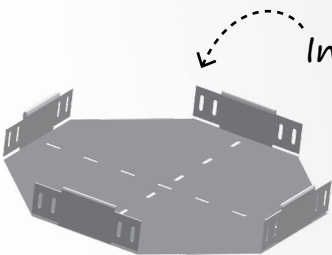

Reducer

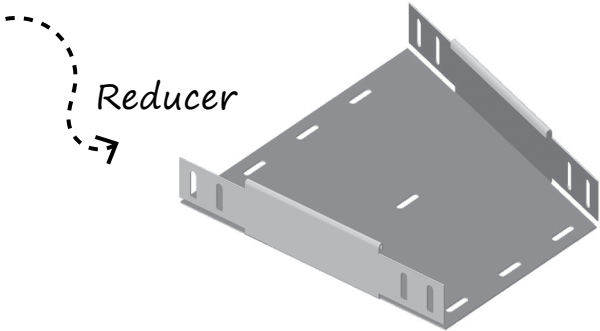

Bend 90°

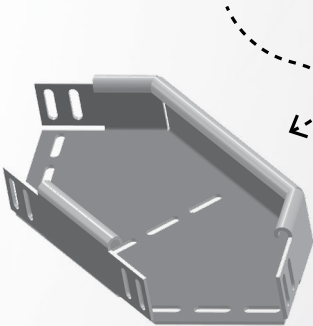

Tee

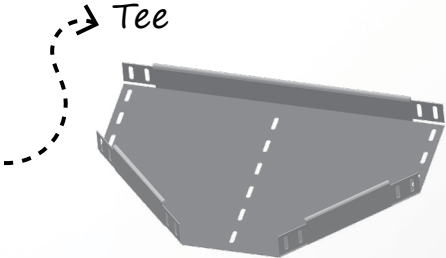

Adjustable Riser

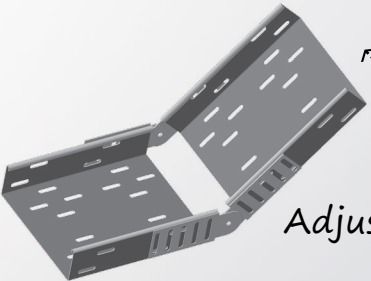

CABLE TRAY FITTINGS

HOW TO ORDER CABLE TRAY FITTINGS

- 1-Refer to page 9 to select the finishing for Mild Steel or the type of Material
- 2-Select CT for cable tray
- 3-Select the width , height
- 4-Select the thickness
- 5-Select Name of Fitting

Order Example :

To select Stainless Steel 304 cable tray Bend 45° with inside returned flange of width 300 mm , side height 75 mm , thickness 2.0 mm

This is the answer SS304-CT-30075-2.0-Bend45



CABLE TRAY ACCESSORIES

Straight Coupler



Horizontal Adjustable Coupler



Vertical Adjustable Connector



End Plate

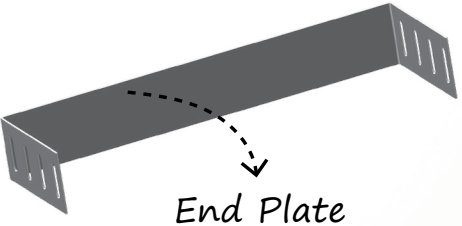

Angle Type Coupler

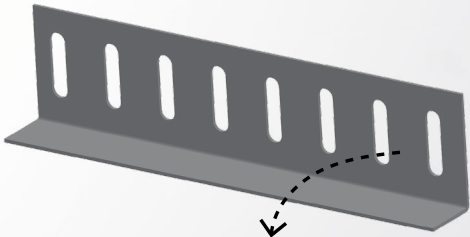

CABLE TRUNKING

Kivolt cable management and accessories are manufactured in compliance with BS EN 61537, 2001/BS 5750/BS EN 10130/BS EN 10131/BS EN 10051 and NEMA standards. And, as per cabling standards CENELEC EN 50173-1; EIA/ITA 568 A; ISO/IEC 11801; 2002.

KIVOLT Cable Trunking is available in :

Single Compartment

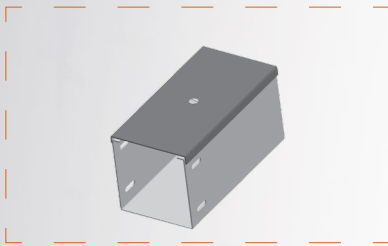

Double Compartment

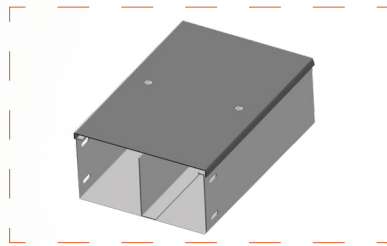

Triple Compartment

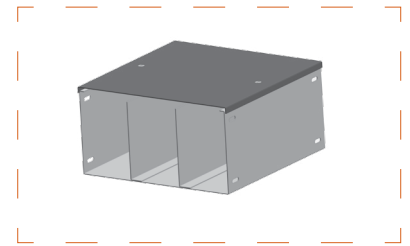

SPECIFICATION

- Refer to page 10 | For Straight Cable Trunking

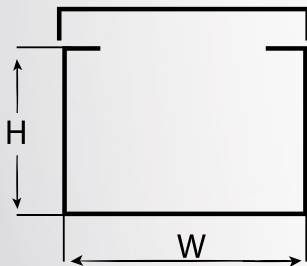

The below table shows the standard dimensions & finishings for KIVOLT Cable Trunking

W (mm)	H (mm)	THICKNESS	FINISHING
50	50	1.0, 1.2, 1.5, 2.0 mm	EG, MG, HDG, SS304, SS316, AL1100
75	50		
75	75		
100	50		
100	75		
100	100		
150	100		
150	150		
200	100		
200	150		
200	200		
300	50		
300	100		

Available Length: 2.0 m , 2.44 m ,3.0 m
For other dimensions ..feel free to contact Kivolt Team.

HOW TO ORDER STRAIGHT CABLE TRUNKING

1-Refer to page 9 to select the finishing for Mild Steel or the type of Material

2-Select TR for cable trunking

3-Select the width , height

4-Select the thickness

5-Select the length

6-Select number of compartments (S: For Single ,D: For Double ,T:For Triple)

Order Example :

To select mill galvanized 3-compartment cable trunking of width 225 mm , side height 75 mm , thickness 2.0 mm and length 2.44 m . This is the answer MG-TR-15075-1.0-2.44-T



CABLE TRUNKING FITTINGS

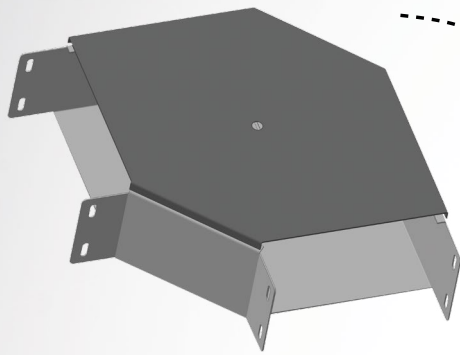

Bend 45 ° with Top Lid

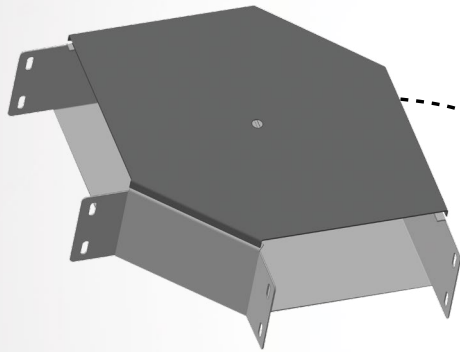

Bend 90 ° with Top Lid

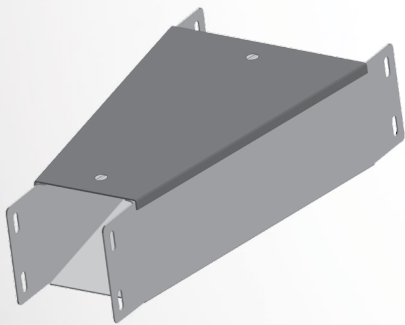

Reducer with Top Lid

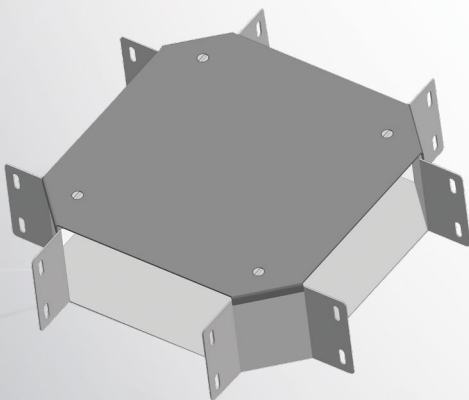

Intersection with Top Lid

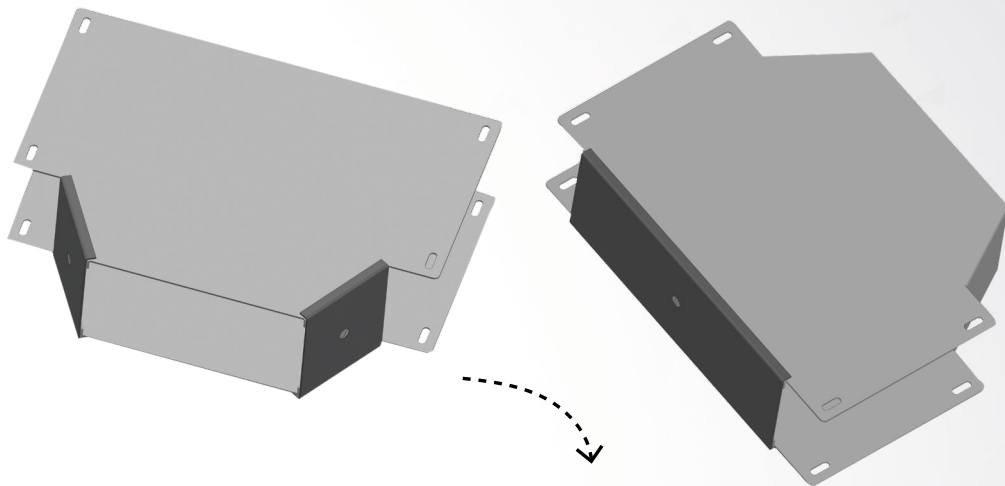

Tee with Inside & Outside Lid

Inside & Outside Cable Trunking Fittings are available upon request.

HOW TO ORDER CABLE TRUNKING FITTINGS

1-Refer to page 9 to select the finishing for Mild Steel or the type of Material

2-Select TR for cable trunking

3-Select the width , height

4-Select the thickness

5-Select the fitting type

6-Select number of compartments (S: For Single ,D: For Double ,T:For Triple)

Order Example :

To select mill galvanized 2-compartment cable trunking Tee of width 150 mm , side height 50 mm , thickness 1.2 mm. This is the answer MG-TR-15050-1.2-Tee -D

CABLE TRUNKING ACCESSORIES

Straight Coupler

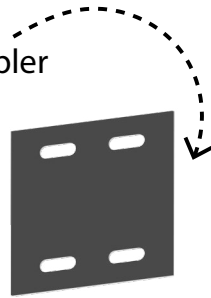

U-shape Coupler

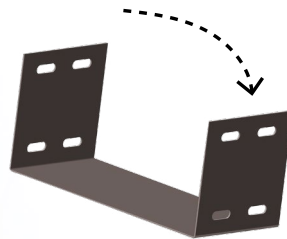

L-shape Coupler

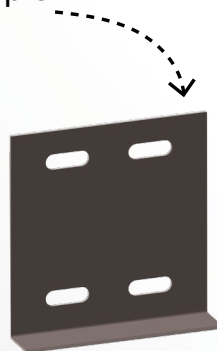

CABLE LADDER

KIVOLT Cable Ladder is developed for use in commercial & industrial applications. Its superior support strength and open ventilation allows for effortless installation of electrical cables. The finished product is constructed from mild Steel side rail sections and rungs welded at 300 mm or 400 mm continuous spacings.

FEATURES

- Returned Flange Type , Inside C- Type , Outside C- Type

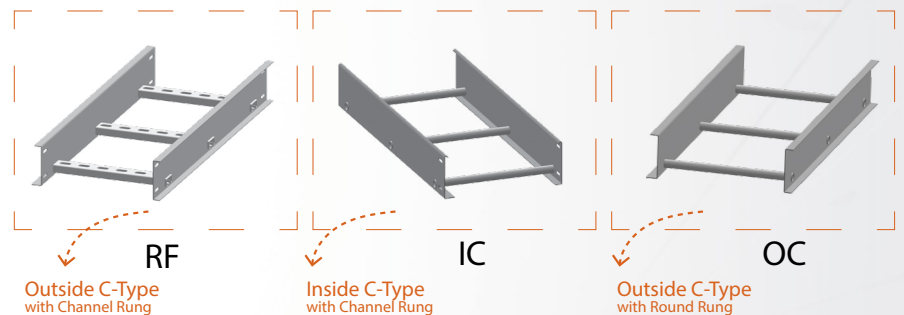

- Plain Type Rung Downward or Upward & Slotted Type Rung Downward or Upward Size 41X21 , 41X41

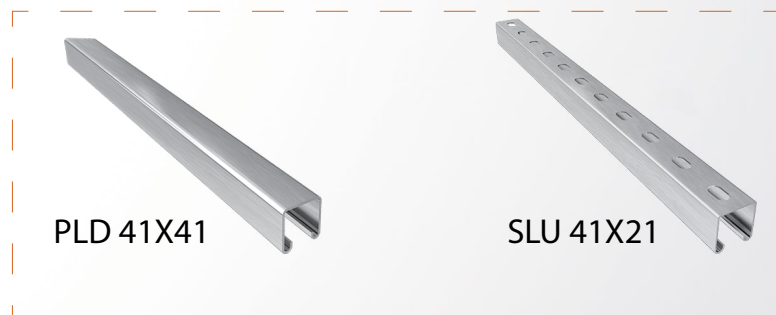

SPECIFICATION

- Refer to page 9

LOAD CAPACITY

-Please contact our technical team to provide you with the suitable load capacity, support spacing and actual deflection.

CABLE LADDER

FOR STRAIGHT CABLE LADDER

- The below table show the standard dimensions and finishing for KIVOLT Perforated Cable Ladder.

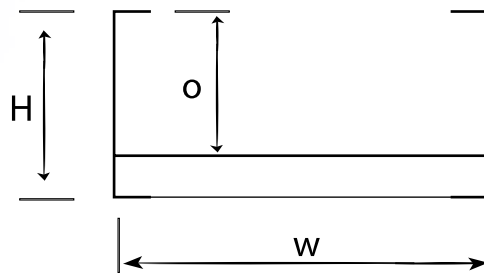

Width W (mm)	100	150	200	250	300	400	450	500	600	700	750	800	900	1000	1200	
Height H (mm)	50		75			100			125			150				
Thickness of Rail (mm)	1.5				20			2.5								
Length (m)	2.44					3.0										
Rung Type	PLD 41X21	PLU 41X21	PLD 41X41	PLU 41X41	SLD 41X21	SLU 41X21	SLD 4X41									
Rung Spacing	400					300										
Type of Flange	RF					IC			OC							
Finishing	EG	MG	HDG	SS304	SS316	AL1100										

For other dimensions ..feel free to contact Kivolt Team.

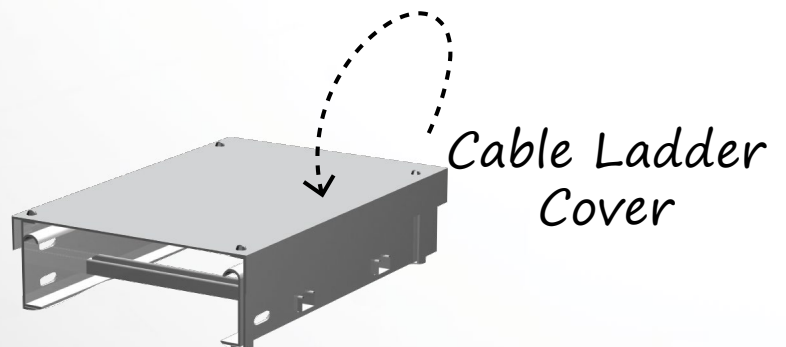

HOW TO ORDER STRAIGHT CABLE LADDER & ITS COVER

1-Refer to page 9 to select the finishing for Mild Steel or the type of Material

2-Select CL for cable Ladder

3-Select the width , height

4-Select the thickness

5-Select the length

6-Select type of Flange

7-Select the rung type

8-Select the rung size

9-Select the rung thickness

10-Select the rung spacing

11-Select Cover by adding it after specifying the length for the tray .

Order Example :

To select hot dipped galvanized cable ladder with outside C-type flange of width 600 m , side height 75 mm, thickness 2.5 mm and length 3 m. Rung is Slotted Upper type 41X21, 2.0 mm thick and 400 mm is its spacing. This is the answer HDG-CL-20075-2.0-3-RF / SLU-4121-2.0-400

To select cover for this hot dipped galvanized cable Ladder with thickness 2.0 mm. This is the answer HDG-CT-20075-2.0-3-RF-Cover

CABLE LADDER FITTINGS

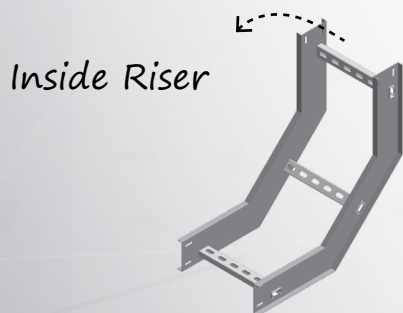
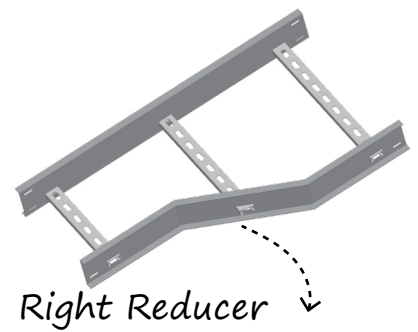
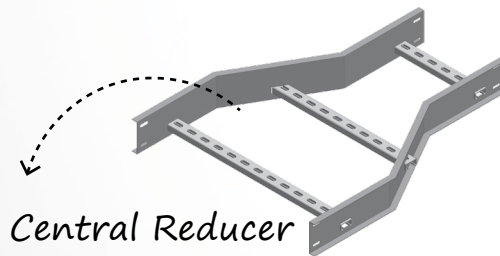
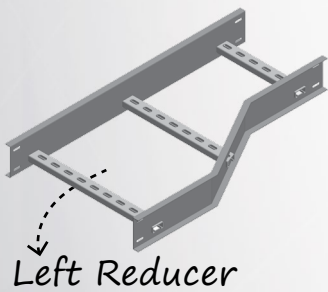
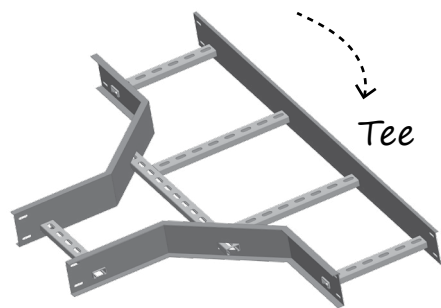
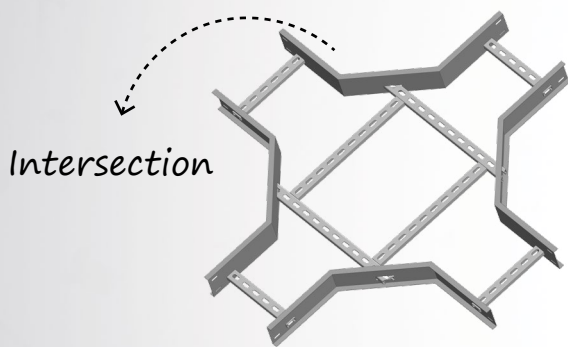
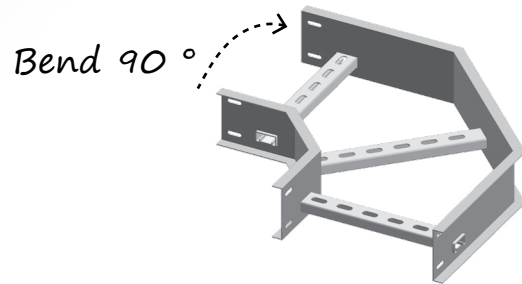
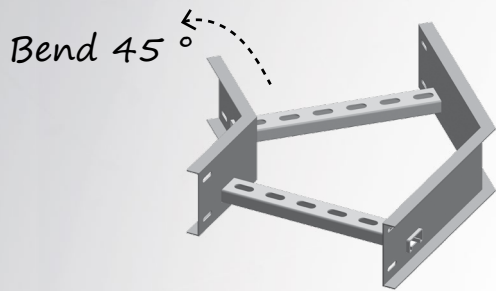

HOW TO ORDER CABLE LADDER FITTINGS

1-Refer to page 9 to select the finishing for Mild Steel or the type of Material

2-Select CL for cable Ladder

3-Select the width , height

4-Select the thickness

5-Select Name of Fitting

6-Select the flange type

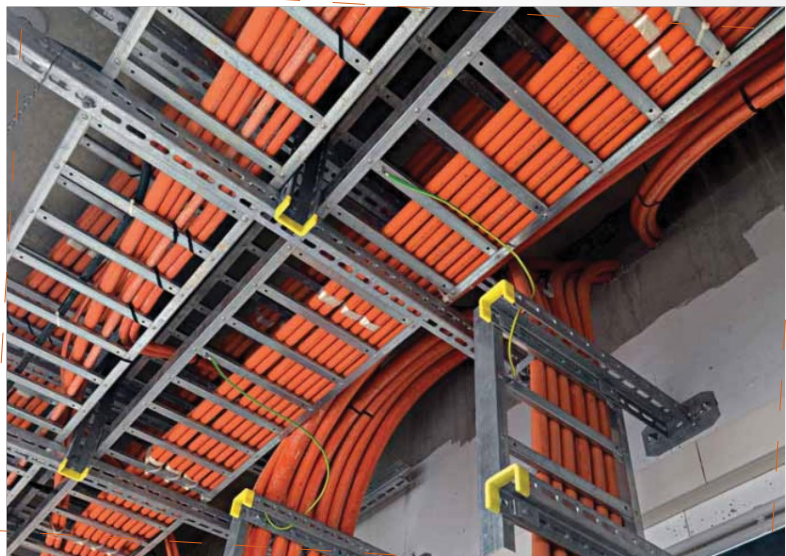

Order Example :

To select Stainless Steel 316 cable Ladder Inside Riser with inside returned flange of width 900 mm , side height 150mm , thickness 2.0 mm .Rung is Slotted Downward type 41X21 ,2.0 mm thick and 300 mm is its spacing . This is the answer SS316-CL-900150-2.0-Bend45-RF

CABLE LADDER ACCESSORIES

Straight Coupler



Horizontal Adjustable Coupler

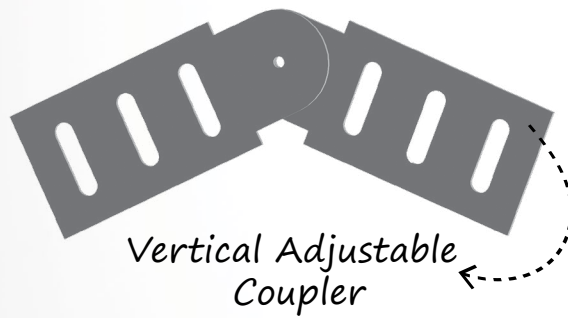
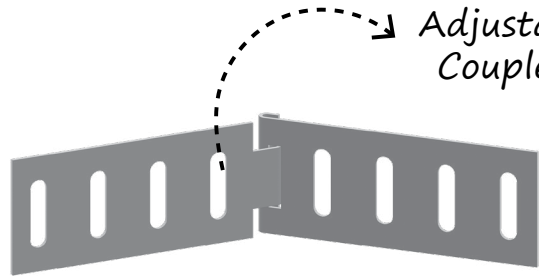

Vertical Adjustable Coupler

End Plate

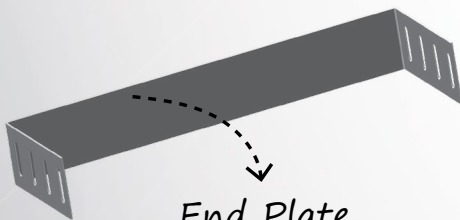

Angle Type Coupler

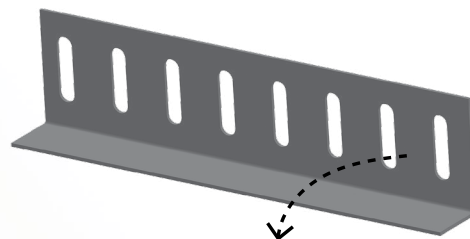

SUPPORT SYSTEM

CABLE LADDER COVER

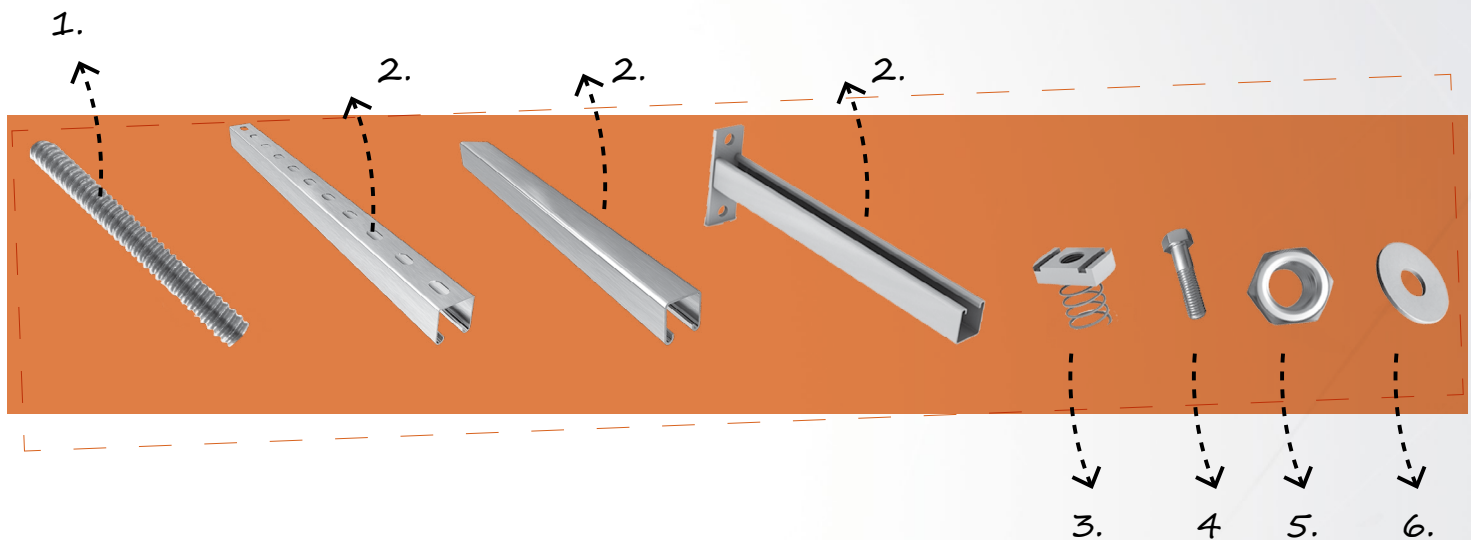

1- Threaded Rod with diameter M6, M8, M10, M12, M14, M16, M20
 Finishes : Electro-galvanized, Hot Dipped Galvanized, Stainless Steel 316

2- Unistrut Channel : 41x41, 41x21
 Finishes : Electro-galvanized , Hot Dipped Galvanized ,Stainless Steel 316
 Thickness : 1.5 mm , 2.0 mm, 2.5 mm

3- Spring Nut : M6, M8,M10,M12
 Finishes : Electro-galvanized , Hot Dipped Galvanized, Stainless Steel 316

4-Hexagonal Bolt M6, M8,M10,M12,M16
 Finishes : Electro-galvanized , Hot Dipped Galvanized , Stainless Steel 316

5- Hexagonal Nut M6, M8,M10,M12,M16
 Finishes : Electro-galvanized, Hot Dipped Galvanized, Stainless Steel 316

6-Round Washer : M6, M8,M10,M12
 Finishes : Electro-galvanized, Hot Dipped Galvanized, Stainless Steel 316

7-Anchor
 Please contact our technical team to provide with the suitable anchors since it varies as per the type of structure (cracked concrete , hollow block , solid block ,....)

> CONTACT US

☎ **MOB: +961 3 905 981**
TEL: +961 1 84 01 29

📍 Lebanon Beirut
Mazraa Al Rida Bldg. 3rd floor.

✉ office@kivolt-lb.com

▲ www.kivolt-lb.com